

St. Anthony Park Elementary Renovation

Update to St. Anthony Park Community Council
November 2016 Board Meeting



Project Progress and Schedule

School & Community Engagement	Spring 2016
Design & Documentation	Summer - Fall 2016
Site Plan Review	November 2017
Variance Application	November 2017
Easement Application	November 2017
Watershed Review	November 2017
Neighborhood Engagement – Transportation	Winter 2016-17
Plan Review	January 2017
Bidding	January – February 2017
Construction	Summer 2017 - Fall 2018



Site Concept Plan

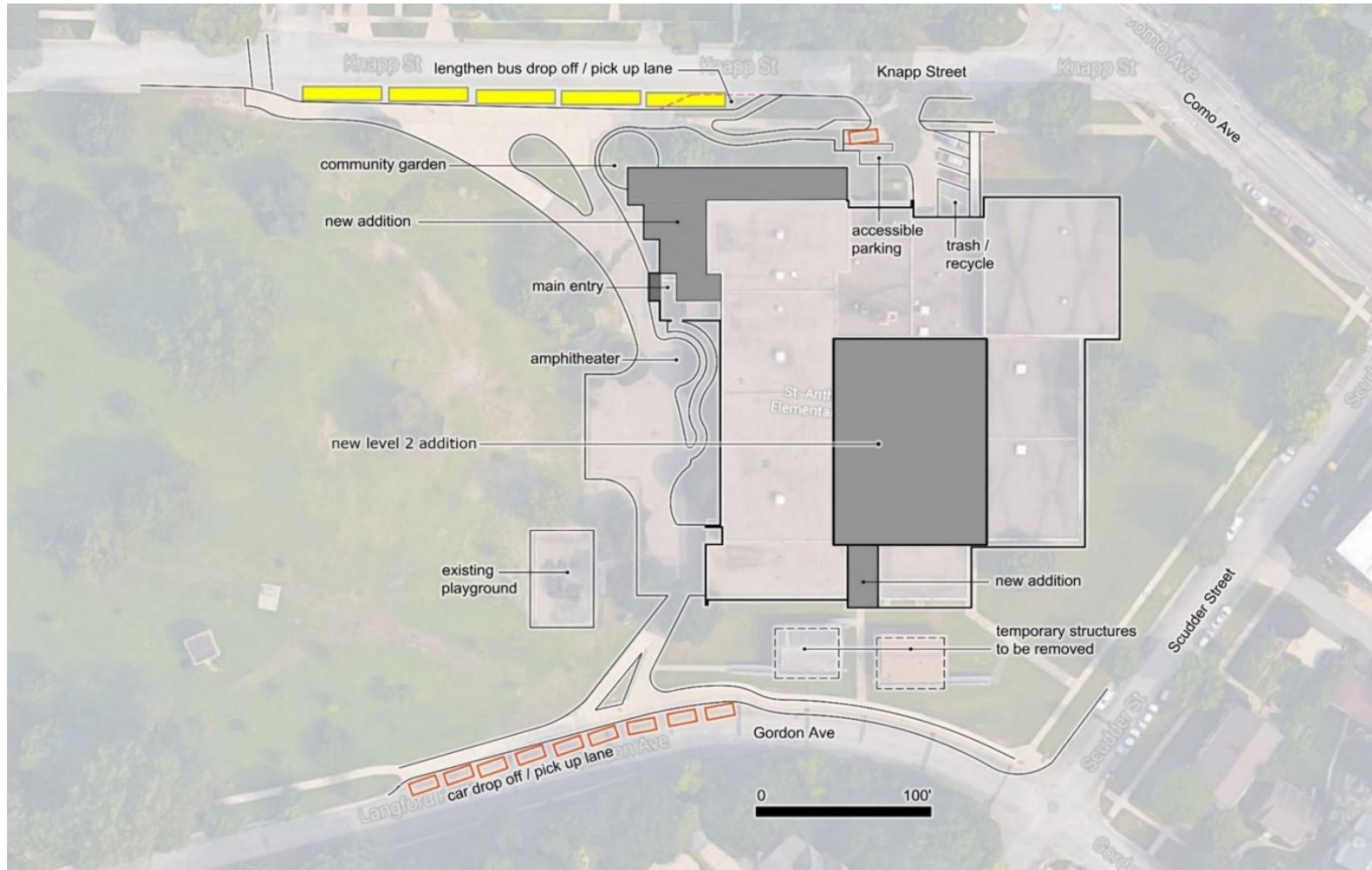

First Floor Conceptual Plan



Second Floor Conceptual Plan



St. Anthony Park Elementary School - Addition & Remodeling - Level 2 Diagram

ST. PAUL PUBLIC SCHOOLS | ST. PAUL, MN

11/10/2016

CUNNINGHAM
GROUP



Entry Rendering from Langford Park



Cafeteria Rendering



Media Center First Floor Rendering



Media Center Second Floor Rendering



Project Variance Requests

Site Coverage

Zoning allowable site coverage (R1 Zone)	35%
Current building site coverage (excluding portables)	38.6%
Proposed building site coverage	41.9%

Parking Requirements

Parking stalls required due to additional building area (1 per additional staff)	10
Additional parking stalls proposed	1



Project Easement Encroachment Request

The city holds an Easement on the vacated roadway between St. Anthony Park Elementary and Langford Park for existing water, storm sewer, and sanitary sewer lines. To renovate the front entry we're requesting the city allow the stairs, landing, and ramp to be constructed in the easement.

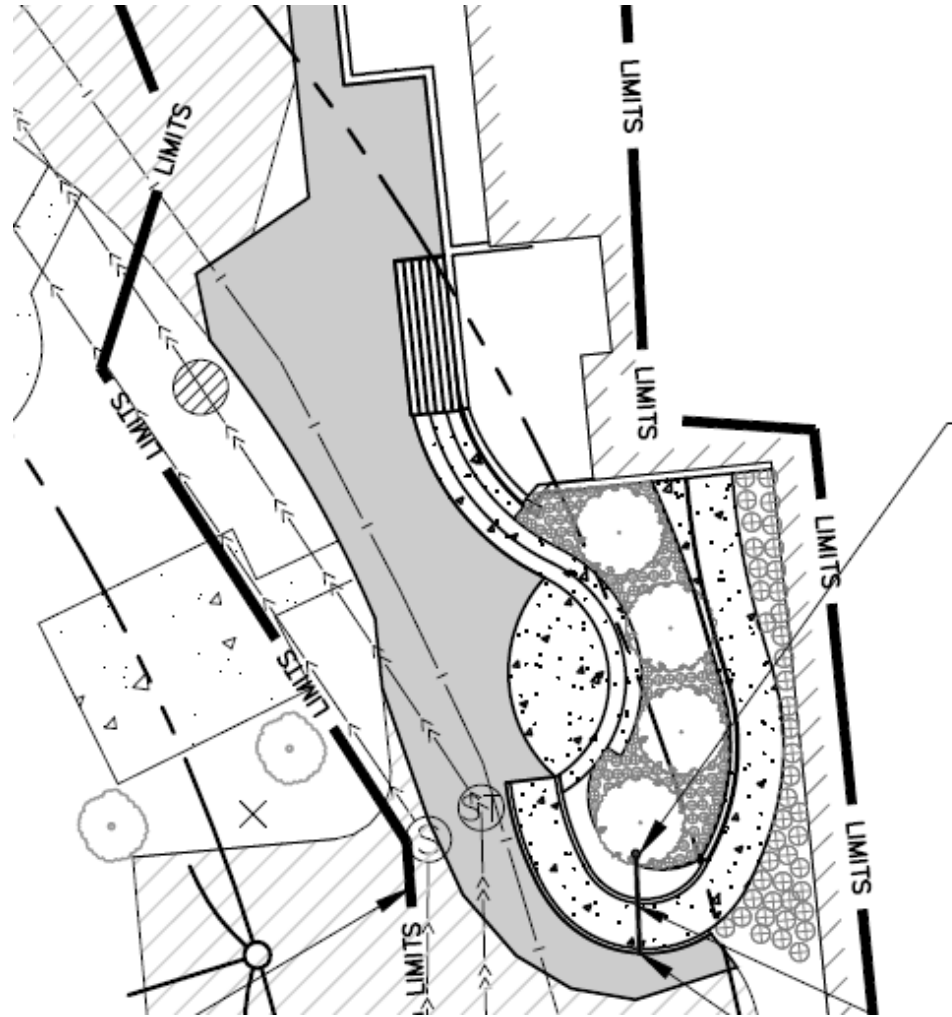

Preliminary Construction Staging Proposal

Due to the compact nature of the school site, St. Paul Schools will be proposing to utilize St. Paul Parks and Recreation property at Langford park for construction staging space in some fashion from Summer 2017 through Fall of 2018.



QUESTIONS?

651-744-1800

facilities@spps.org

<http://facilities.spps.org/fmp>

